



# Information Technology & Digital Services

## Installing Citrix Workspace iOS

### Introduction

This guide will assist you in setting up the required software for ADAPT. This will only need to be done once per phone/tablet.

### Procedure

#### Installation of Citrix Workspace

1. On your iOS device (iPhone/iPad), search the App Store for Citrix Workspace



2. Install Citrix Workspace.

#### Configuration of Citrix Workspace

3. Open Citrix Workspace on your iOS device
4. Tap 'Get Started'
5. Enter "adapt.adelaide.edu.au" for Store URL and tap 'Continue'

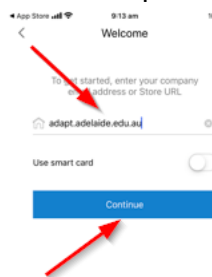

1. You will automatically be taken to the Multi-Factor Authentication (MFA) Okta to log in and authenticate. If you have not yet registered for MFA, registration instructions are available in the [MFA guide](#) or on the [MFA Webpage](#)
6. Enter your university Username eg: a1234567, your Password and click Sign in

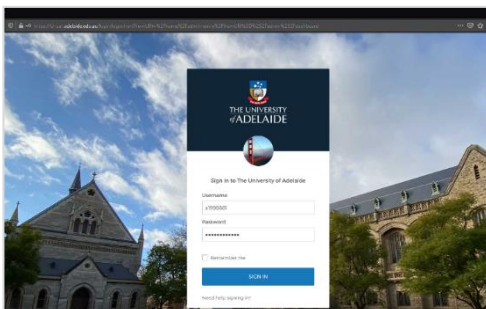

After authenticating, you will return to the ADAPT where you will now see your Workspace, but we don't have any applications yet! Lets add the ADAPT Student Desktop

1. On the left hand side, tap the blue box with the white + symbol

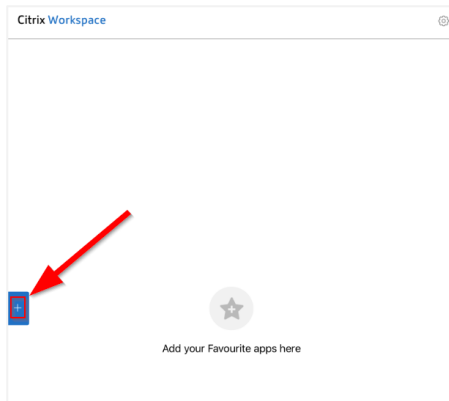

2. This will bring up all of your available applications. Tap on the + symbol next to ADAPT Student desktop

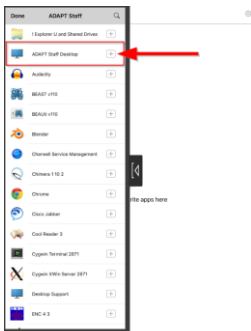

3. You will now see ADAPT Student Desktop has been added to your workspace. You can now tap on the icon to open ADAPT on your iOS device

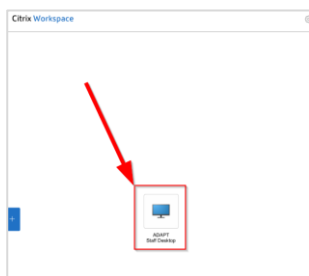

For future access to ADAPT, now Citrix receiver is installed and configured

On your IOS device, open Citrix receiver. Open ADAPT supplied applications.

## Contact Us

For further support or questions, please contact the ITDS Service Desk on +61 8 8313 3000 or [servicedesk@adelaide.edu.au](mailto:servicedesk@adelaide.edu.au)